

MC-CDVMA- Compact VDMA 21287

ISO21287 COMPACT CYLINDERS



	<i>COVERS</i>	<i>DIE-CASTED ALUMINIUM</i>
	<i>TUBE</i>	<i>ANODIZED ALUMINIUM</i>
	<i>SEALS</i>	<i>POLYURETHANE+NBR</i>
	<i>BUSH</i>	<i>SINTERED BRONZE</i>
	<i>PISTON ROD</i>	<i># 20-25 STAINLESS STEEL Aisi 302</i> <i># 32-100 CHROMIUM COATED STEEL</i>

<i>WORKING PRESSURE</i>	<i>TEMPERATURE</i>	<i>WORKING FLUID</i>
MAX 10 BAR	-20°C +80°C WITH DRY AIR	FILTERED AND LUBRICATED OR NOT COMPRESSED AIR

Order Code

Series	Type	Bore	Stroke
MC-CVDMA	10	Male Rod Stainless Double Acting	12 > 60
	11	Male Rod Chrome Double Acting	16 > 60
	12	Female Rod Chrome Double Acting	20 > 80
	9	Female Rod Stainless Double Acting	25 > 80
	21	Through Rod Male Chrome Double Acting	32 > 80
	29	Through Rod Female Stainless Double Acting	40 > 80
	31	Through Rod Male Chrome Double Acting	50 > 100
	39	Through Rod Female Stainless Double Acting	63 > 100
	13	Single Acting Male Chrome Spring Extend	80 > 115
	14	Single Acting Female Chrome Spring Extend	100 > 125
	17	Single Acting Male Stainless Spring Extend	
	18	Single Acting Female Stainless Spring Extend	
	15	Single Acting Male Chrome Spring Return	
	16	Single Acting Female Chrome Spring Return	
	15	Single Acting Male Stainless Spring Return	
	16	Single Acting Female Stainless Spring Return	

All Cylinders Are Magnetic As Standard

***** Note Longer Strokes Available Upon Request *****

Dimensions Double Acting (Female Rod)

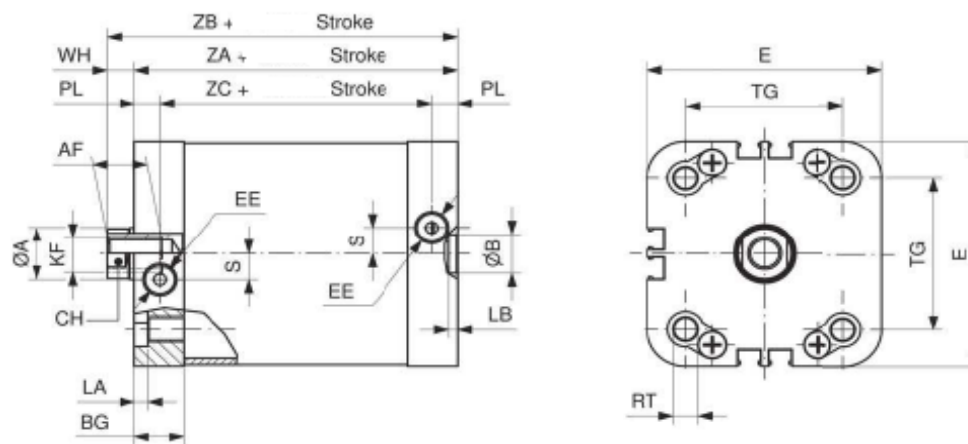

DIMENSIONS

Ø mm	ØA	CH	AF	WH	ZA	ZB	ZC	KF	EE	BG	TG	E	RT	LA	PL	ØB	LB	S
20	10	9	10	6	37	43	23	M6X1	M5X0.8	14.25	22	36	M5X0.8	3	7	9	2.1	2.5
25	10	9	10	6	39	45	25	M6X1	M5X0.8	14	26	39.5	M5X0.8	3	7	9	2.1	2.5
32	12	10	12	7	44	51	28.5	M8X1.25	1/8"G	15.5	32.5	49.5	M6X1	3.5	7.75	9	2.1	6
40	12	10	12	7	45	52	29.5	M8X1.25	1/8"G	15.5	38	54	M6X1	3.5	7.75	9	2.1	8
50	16	13	16	8	45	53	29.5	M10X1.5	1/8"G	14.5	46.5	69	M8X1.25	4	7.5	12	2.6	8
63	16	13	16	8	49	57	33.5	M10X1.5	1/8"G	15.5	56.5	79	M8X1.25	4	7.75	12	2.6	11.5
80	20	17	20	10	54	64	36.5	M12X1.75	1/8"G	17.5	72	94.5	M10X1.5	5	8.75	12	2.6	11.5
100	25	21	20	10	67	77	46	M12X1.75	1/8"G	21	89	114.5	M10X1.5	5	10.5	12	2.6	20

Dimensions Double Acting Male Rod.

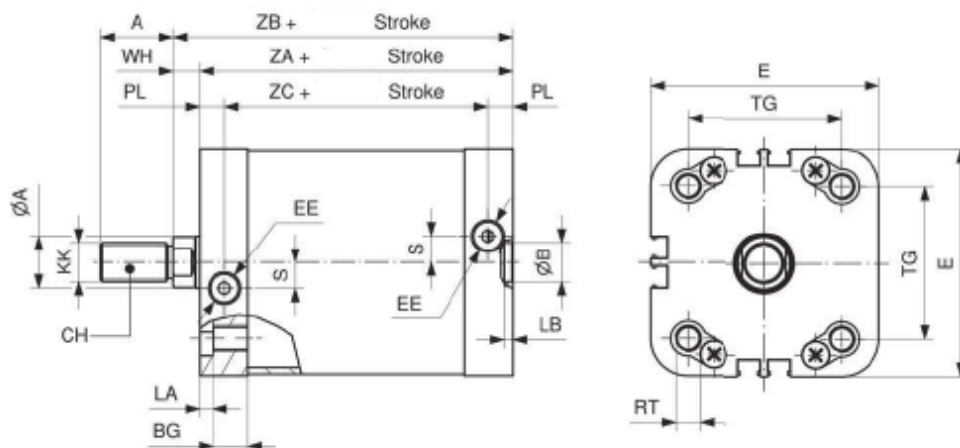

DIMENSIONS

Ø mm	ØA	CH	A	WH	ZA	ZB	ZC	KK	EE	BG	TG	E	RT	LA	PL	ØB	LB	S
20	10	9	16	6	37	43	23	M8X1.25	M5X0.8	14.25	22	36	M5X0.8	3	7	9	2.1	2.5
25	10	9	16	6	39	45	25	M8X1.25	M5X0.8	14	26	39.5	M5X0.8	3	7	9	2.1	2.5
32	12	10	19	7	44	51	28.5	M10X1.5	1/8"G	15.5	32.5	49.5	M6X1	3.5	7.75	9	2.1	6
40	12	10	19	7	45	52	29.5	M10X1.5	1/8"G	15.5	38	54	M6X1	3.5	7.75	9	2.1	8
50	16	13	22	8	45	53	29.5	M12X1.75	1/8"G	14.5	46.5	69	M8X1.25	4	7.5	12	2.6	8
63	16	13	22	8	49	57	33.5	M12X1.75	1/8"G	15.5	56.5	79	M8X1.25	4	7.75	12	2.6	11.5
80	20	17	28	10	54	64	36.5	M16X1.5	1/8"G	17.5	72	94.5	M10X1.5	5	8.75	12	2.6	11.5
100	25	21	28	10	67	77	46	M16X1.5	1/8"G	21	89	114.5	M10X1.5	5	10.5	12	2.6	20

Dimensions Single Acting Female Rod.

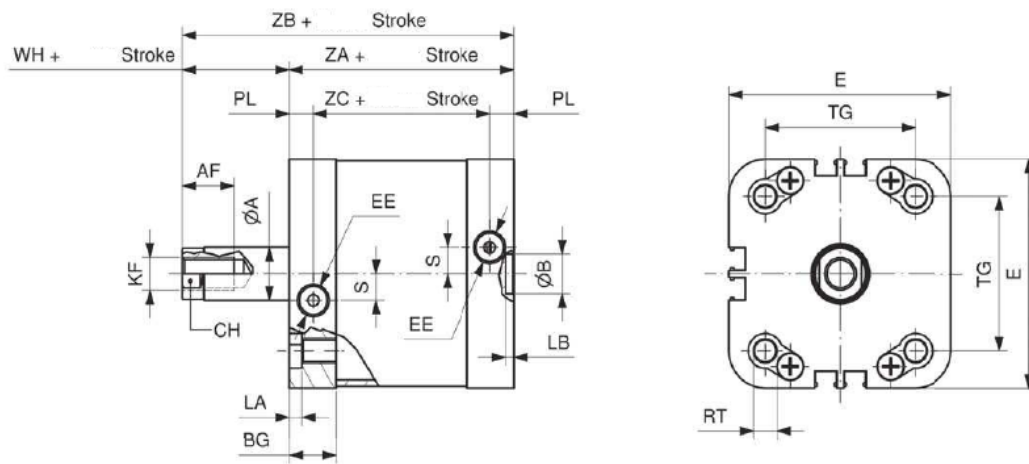

DIMENSIONS

Ø mm	ØA	CH	AF	WH	ZA	ZB	ZC	KF	EE	BG	TG	E	RT	LA	PL	ØB	LB	S
20	10	9	10	6	37	43	23	M6X1	M5X0.8	14.25	22	36	M5X0.8	3	7	9	2.1	2.5
25	10	9	10	6	39	45	25	M6X1	M5X0.8	14	26	39.5	M5X0.8	3	7	9	2.1	2.5
32	12	10	12	7	44	51	28.5	M8X1.25	1/8"G	15.5	32.5	49.5	M6X1	3.5	7.75	9	2.1	6
40	12	10	12	7	45	52	29.5	M8X1.25	1/8"G	15.5	38	54	M6X1	3.5	7.75	9	2.1	8
50	16	13	16	8	45	53	29.5	M10X1.5	1/8"G	14.5	46.5	69	M8X1.25	4	7.5	12	2.6	8
63	16	13	16	8	49	57	33.5	M10X1.5	1/8"G	15.5	56.5	79	M8X1.25	4	7.75	12	2.6	11.5
80	20	17	20	10	54	64	36.5	M12X1.75	1/8"G	17.5	72	94.5	M10X1.5	5	8.75	12	2.6	11.5
100	25	21	20	10	67	77	46	M12X1.75	1/8"G	21	89	114.5	M10X1.5	5	10.5	12	2.6	20

Dimensions Single Acting Male Rod.

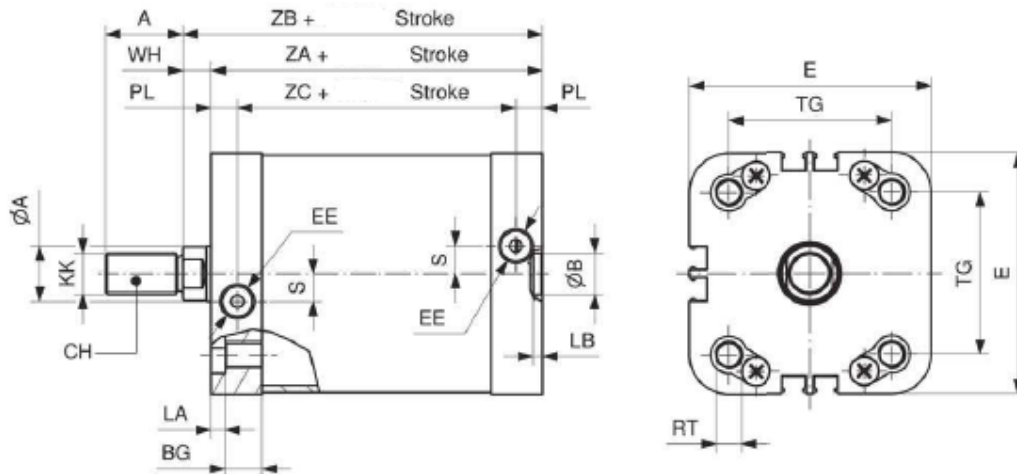

DIMENSIONS

Ø mm	ØA	CH	A	WH	ZA	ZB	ZC	KK	EE	BG	TG	E	RT	LA	PL	ØB	LB	S
20	10	9	16	6	37	43	23	M8X1.25	M5X0.8	14.25	22	36	M5X0.8	3	7	9	2.1	2.5
25	10	9	16	6	39	45	25	M8X1.25	M5X0.8	14	26	39.5	M5X0.8	3	7	9	2.1	2.5
32	12	10	19	7	44	51	28.5	M10X1.5	1/8"G	15.5	32.5	49.5	M6X1	3.5	7.75	9	2.1	6
40	12	10	19	7	45	52	29.5	M10X1.5	1/8"G	15.5	38	54	M6X1	3.5	7.75	9	2.1	8
50	16	13	22	8	45	53	29.5	M12X1.75	1/8"G	14.5	46.5	69	M8X1.25	4	7.5	12	2.6	8
63	16	13	22	8	49	57	33.5	M12X1.75	1/8"G	15.5	56.5	79	M8X1.25	4	7.75	12	2.6	11.5
80	20	17	28	10	54	64	36.5	M16X1.5	1/8"G	17.5	72	94.5	M10X1.5	5	8.75	12	2.6	11.5
100	25	21	28	10	67	77	46	M16X1.5	1/8"G	21	89	114.5	M10X1.5	5	10.5	12	2.6	20

Through Rod Double Acting Female Rod.

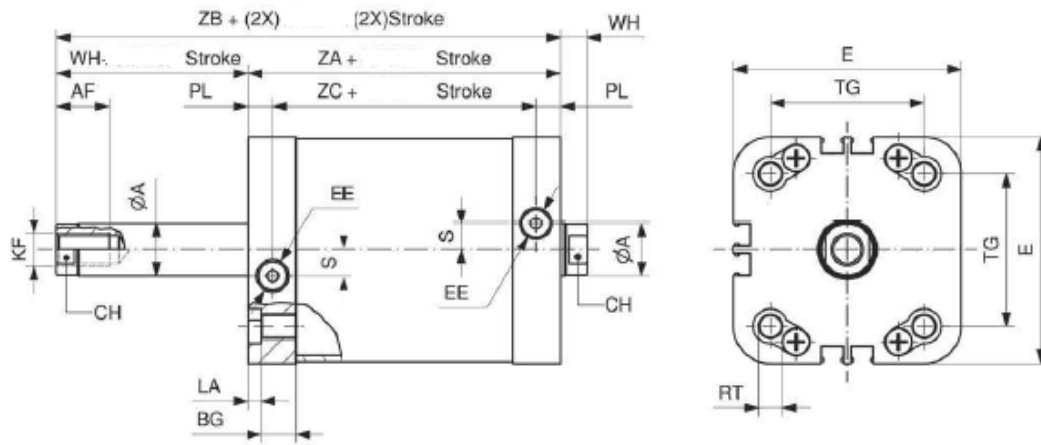

DIMENSIONS

Ø mm	ØA	CH	AF	WH	ZA	ZB	ZC	Kf	EE	BG	TG	E	RT	LA	PL	ØB	LB	S
20	10	9	10	6	37	43	23	M6X1	M5X0.8	14.25	22	36	M5X0.8	3	7	9	2.1	2.5
25	10	9	10	6	39	45	25	M6X1	M5X0.8	14	26	39.5	M5X0.8	3	7	9	2.1	2.5
32	12	10	12	7	44	51	28.5	M8X1.25	1/8" G	15.5	32.5	49.5	M6X1	3.5	7.75	9	2.1	6
40	12	10	12	7	45	52	29.5	M8X1.25	1/8" G	15.5	38	54	M6X1	3.5	7.75	9	2.1	8
50	16	13	16	8	45	53	29.5	M10X1.5	1/8" G	14.5	46.5	69	M8X1.25	4	7.5	12	2.6	8
63	16	13	16	8	49	57	33.5	M10X1.5	1/8" G	15.5	56.5	79	M8X1.25	4	7.75	12	2.6	11.5
80	20	17	20	10	54	64	36.5	M12X1.75	1/8" G	17.5	72	94.5	M10X1.5	5	8.75	12	2.6	11.5
100	25	21	20	10	67	77	46	M12X1.75	1/8" G	21	89	114.5	M10X1.5	5	10.5	12	2.6	20

Through Rod Double Acting Male Rod.

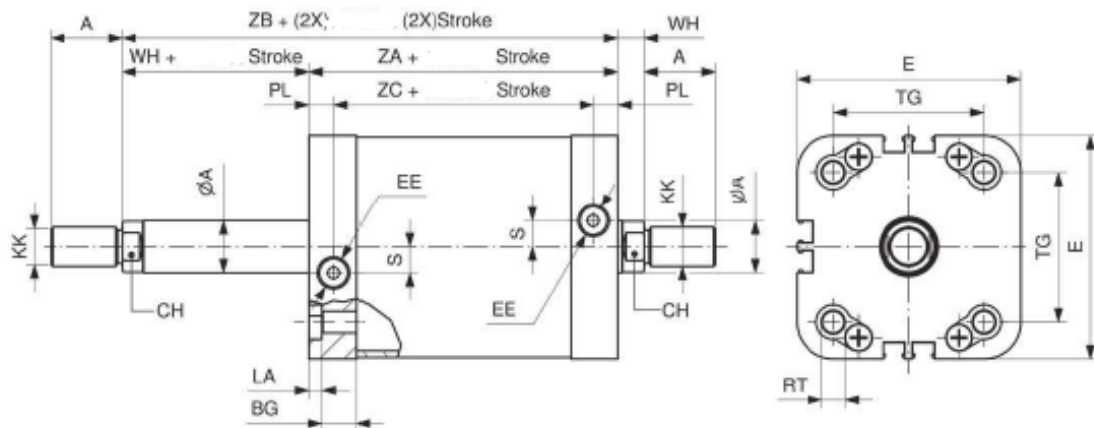







DIMENSIONS

Ø mm	ØA	CH	A	WH	ZA	ZB	ZC	Kk	EE	BG	TG	E	RT	LA	PL	ØB	LB	S
20	10	9	16	6	37	43	23	M8X1.25	M5X0.8	14.25	22	36	M5X0.8	3	7	9	2.1	2.5
25	10	9	16	6	39	45	25	M8X1.25	M5X0.8	14	26	39.5	M5X0.8	3	7	9	2.1	2.5
32	12	10	19	7	44	51	28.5	M10X1.5	1/8" G	15.5	32.5	49.5	M6X1	3.5	7.75	9	2.1	6
40	12	10	19	7	45	52	29.5	M10X1.5	1/8" G	15.5	38	54	M6X1	3.5	7.75	9	2.1	8
50	16	13	22	8	45	53	29.5	M12X1.75	1/8" G	14.5	46.5	69	M8X1.25	4	7.5	12	2.6	8
63	16	13	22	8	49	57	33.5	M12X1.75	1/8" G	15.5	56.5	79	M8X1.25	4	7.75	12	2.6	11.5
80	20	17	28	10	54	64	36.5	M16X1.5	1/8" G	17.5	72	94.5	M10X1.5	5	8.75	12	2.6	11.5
100	25	21	28	10	67	77	46	M16X1.5	1/8" G	21	89	114.5	M10X1.5	5	10.5	12	2.6	20

Accessories / Switches.

Mounting Brackets / Accessories As MCQI.

CB-Pin Female Rear Clevis		CA Male Rear Clevis	
CDB Offset Rear Clevis		Y Front Clevis	
LB Foot Mounting Bracket		PHS Spherical Rod Eye	
FAC Front Flange			
RCI (Reed Switch 3M Cable) RCI-5m (Reed Switch 5M Cable) RCI-QD (Reed Switch With M8 Plug) RNI (RPI) Inductive Swich 3M NPN / PNP RNI (RPI) -5M Inductive Swich 3M NPN / PNP RNI (RPI)-EQD (Switch With M8 Plug) M83R-PVC-5M (Lead + Plug For RCI-EQD/RNI/RPI-EQD)		