

# Clamping Elements For Linear Guides and Shafting

THE DYNAMICS OF MOVEMENT

**CLAMPING ELEMENTS FROM MATARA:**  
 Matara's range of linear motion clamping elements suit Linear Rail and Shafting, with both manual and pneumatic types available. The Shafting type suits diameters from as small as  $\varnothing 12$  all the way up to  $\varnothing 60$ . Furthermore, the Linear Rail type suits linear rail sizes from 9 all the way up to 65.

## Clamping Elements Order Example

Code: **FRC** **15** **T** **SE**

Options: 1 2 3 4

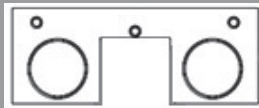
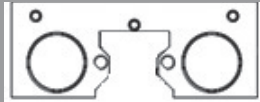
Options		Clamping Elements			
1	Series	FRC, FRCDP, FRCDPH, FRCDPM, FRCMC, FRCC, FRCMAN-M LT, FRCCMAN LT, FRCMAN LT			
2	Guide/ Shaft Size	15-65		12-60	
3	Guide Type	T Type= 		*Only for FRCDPM S Type= 	
4	Clamp Type (Only for linear rail clamps)	<b>SE</b> Single action configuration "Normally Open" - Air to close	<b>SEM</b> Single action configuration "Normally Closed" - Air to open	<b>DE</b> Double action configuration "Normally Open" - Air to close and to open	<b>DEM</b> Double action configuration "Normally Closed" - Air to open and to close

# FRCDPM Clamping and Braking Element

Braking element with high clamping force.  
Material and shape of contact parts allow high clamping force without damaging the rail.



### FRCDPMS SEM FRCDPMS DEM

- Locking element without the use of energy
- High clamping force thanks to a double piston system
- Short reaction times
- Compact and rigid body
- Clamping in case of pressure drop
- Working in emergency stop

Guide size: 25 ~ 55  
Guide type: T  
Working type: Norm. Closed  
Body: Steel  
Operating Temp: -20°C ~ 80°C  
Operating Pressure: 5,5 ~ 8 bar

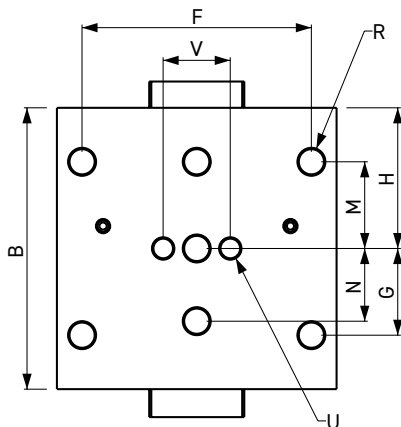
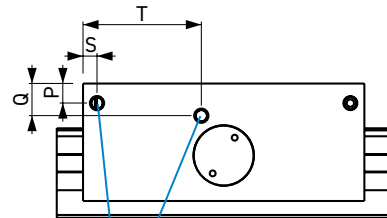
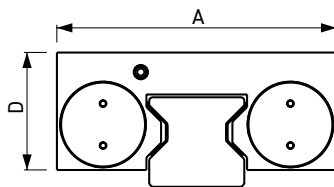

**M5  
AIR CONNECTION**  
we recommend  
the use of compressed  
air hose  $\varnothing$  6x4

Model No.	Guide Type and Size	Clamping Force (N)		A [mm]	B [mm]	D [mm]	F [mm]	G [mm]	H [mm]	M [mm]	N [mm]	P [mm]	Q [mm]	R	S [mm]	T [mm]	U	V [mm]
		SEM	DEM															
FRCDPM	S 25	1500	3900	70	99	32.5	57	22.5	49.5	22.5	20	7.75	5.25	M8x7	5	56	M6x7	20
FRCDPM	S 30	2100	5600	90	109	38	72	22	54.5	26	22	9	6	M10x8	5	47	M8x8	22
FRCDPM	S 35	2600	6600	100	100.6	42	82	31	50.3	31	26	7	11.5	M10x10	5	42.3	M8x10	24
FRCDPM	T 35	2600	6600	108	100.6	42	82	31	50.3	31	26	7	11.5	M10x10	5	42.3	M8x10	24
FRCDPM	S55	7700	9200	140	219	59	116	47.5	109.5	47.5	35	10	17	M14x14	92	92	-	-